

Electric instantaneous
water heater

KDE / KDEZ Bonus electronic

Reliable water heater
with electronic control system

Most important advantages



Copper shielded heating elements
Reliable technology ensures long life, resistance to water decay and air bubbles.



Water flow sensor
Sensor operates at very low pressure 0,1MPa and water flow as little as 2,5 l/min.



Electronic control system
ensures stability and modulation of water temperature from 30°C to 60°C.

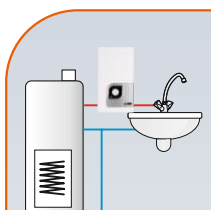

Suitable for cooperation with solar panels and heat pumps
Can work on already pre-heated water. Inletting water temperature up to 70°C.

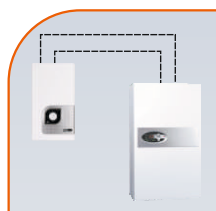

Priority switch
Cooperation with another electric high power consumption appliance.

Application

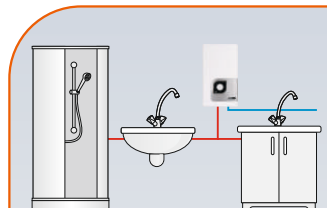

from 12kW

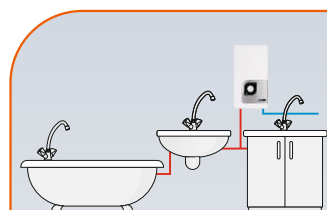

from 18kW

Dimensions

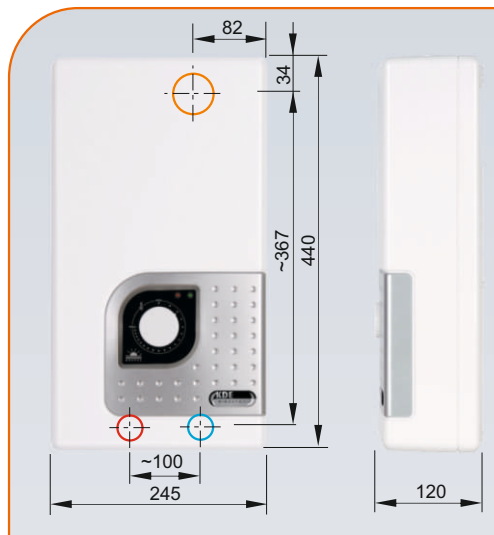

Supply water pressure 0,1 - 0,6 MPa

Inlet and outlet section 1/2" * inner thread

Safety class IP 25

*Inlet and outlet pipes connected to the heater must be made of copper or steel



KDEZ

Metal case with extra resistance to prevent any damage.
Perfect for public buildings.

Technical data

Type	Rated power	Rated voltage	Rated current (A)	Min. connecting wires section (mm ²)	Efficiency (Δt=30°) (l/min.)
KDE-09 BONUS	9 kW	400V 3~	3x13,0	4 x 1,5	4,3
KDE-12 BONUS	12 kW	400V 3~	3x17,3	4 x 2,5	5,8
KDE-15 BONUS	15 kW	400V 3~	3x21,7	4 x 2,5	7,2
KDE-18 BONUS	18 kW	400V 3~	3x26,0	4 x 4	8,7
KDE-21 BONUS	21 kW	400V 3~	3x30,3	4 x 4	10,1
KDE-24 BONUS	24 kW	400V 3~	3x34,6	4 x 6	11,6
KDE-27 BONUS	27 kW	400V 3~	3x39,0	4 x 6	13,0

All technical data is based on standards of Central European countries.
However, Kospel S.A. is fully flexible to adjust its appliances to other standards.