



Electric instantaneous
water heater

PPVE Focus electronic

The first water heater
with LCD touch-screen
display made in Europe

Most important advantages



LCD touch-screen display

Display allows to set the desired water temperature, read the inlet and outlet temperatures, the water flow rate and power with which the unit currently heats



Electronic control

system ensures stability and smooth regulation of water temperature from 30°C to 60°C (1°C step).

9/12/15 kW

18/21/24 kW

3 powers in 1 heater

This allows the user to select the desired power level

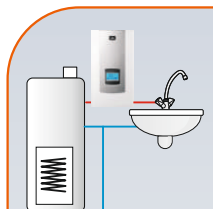

Suitable for cooperation with solar collectors and heat pumps

Can work on already pre-heated water. Inletting water temperature up to 70°C.



Temperature lock

This allows the user to save the maximum temperature value e.g. in order to protect children against burn injuries.

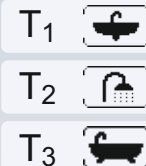

Temperature memory

This allows the user to save three most frequently used water temperature

Dimensions



Supply water pressure 0,1 - 0,6 MPa

Inlet and outlet section 1/2" inner thread

Safety class IP 25

Application

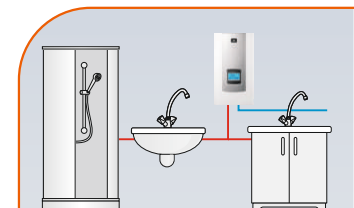

from 12kW

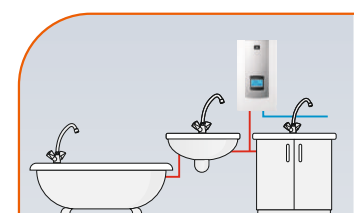

from 18kW

Technical data

Type	Rated power	Rated voltage	Rated current (A)	Min. connecting wires section (mm ²)	Efficiency (Δt=30°C) (l/min.)
PPVE-09/12/15.FOCUS	9/12/15 kW	400V 3~	3 x 13,0/17,3/21,7	4 x 1,5/2,5/2,5	4,3/5,8/7,2
PPVE-18/21/24.FOCUS	18/21/24 kW	400V 3~	3 x 26,0/30,3/34,6	4 x 4/4/6	8,7/10,1/11,6
PPVE-27.FOCUS	27 kW	400V 3~	3 x 39,0	4 x 6	13,0

All technical data is based on standards of Central European countries.
However, Kospel S.A. is fully flexible to adjust its appliances to other standards.